

Information & Booking Conditions

PLEASE READ CAREFULLY BEFORE SIGNING YOUR BOOKING FORM

SMOKING - Smoking is not permitted in our caravans, clubhouse or games room.

OCCUPANCY - Only families and couples will be accepted. The person whose signature appears on the booking form must be over 21 years of age and must occupy the caravan for the duration of the holiday. Only persons named on the booking form can occupy the accommodation. The proprietors must be notified if there are any visitors or additions to the party. Groups of young people cannot be accepted unless accompanied by their parents.

ARRIVALS AND DEPARTURES - The static caravan accommodation will be ready from 4pm on the day of arrival, and must be vacated by 10am on the day of departure. Please ensure the accommodation is left clean and tidy and your key is returned to Reception. Arrivals after 6pm may be permitted, strictly subject to prior arrangement, and may also be subject to a surcharge. As we are a relatively small holiday park and to avoid disturbing other guests, we will not accept arrivals after 9pm.

DEPOSITS - A deposit of £50 per week per unit is required. The balance must be paid 6 weeks before the commencement of your holiday. No reminder will be sent. Deposits are non-refundable.

CANCELLATIONS - Any cancellation must be confirmed in writing. If we are unable to re-let your accommodation, you will be liable for the full cost of the holiday. **You are therefore strongly advised to take out a suitable holiday cancellation policy.** Please note that once you have booked your accommodation and deposits are received, you are entering a legal contract.

FERRY RESERVATIONS - We are happy to book your car ferry for you. Please see tariff sheet for details. Ferry tickets will be issued 2 weeks before date of travel and after receipt of your final balance. An administration charge of £5 will be made for any ferry booking alterations.

PETS - We regret that no pets can be accommodated at Cheverton Copse Holiday Park.

INVENTORY - An inventory is displayed in each caravan. Any missing/broken items or damages to the caravan must be paid for. Any damage to the caravan must be reported to Reception as soon as possible.

BED LINEN - One set of bed linen per guest per week is provided and included in the cost of your holiday. Waterproof bed linen for the young or infirm is not supplied and guests are requested to bring their own. If any additional or replacement bedding is required, it will chargeable at £5 per set.

CLUB HOUSE - Cheverton Copse has a licensed Club which is open during Whitsun week and the school summer holidays (and at other times subject to demand). There is entertainment 7 nights a week during Whitsun and the school summer holidays. The Club also has a big screen TV. Children under 14 are permitted, but only when accompanied by an adult. Please note that due to their closer proximity to the clubhouse, caravans 25-31 could be subject to minimal noise disturbance between 7:30pm - 11pm

GAMES ROOM - Our Games Room is open daily from March to October. It has two pool tables, video games and gaming machines.

SPECIAL NEEDS - Please note that some areas of the park may not be suitable for guests with mobility problems as there are slopes/gradients to some of the caravans. Please mention at time of booking and we will be able to advise you accordingly.

CREDIT CARDS - Payment by credit card will attract a 1.5% surcharge due to the increasing charges imposed by card issuers. Debit cards will not incur any transaction fee.

GENERAL - The Proprietors will immediately terminate your holiday contract should any person be involved in conduct prejudicial to the well-being of others. The Proprietors reserve the right to enter the accommodation if required, primarily for maintenance purposes. On no occasion should children be left alone in a caravan or on the park without supervision, particularly when using the play equipment. The static caravan park is a traffic free area for the safety of children and for this reason cars must be left in the car park. Trolleys are available for the transportation of luggage. Guests bringing two cars must inform Reception at time of booking. Cheverton Copse will not be responsible for any loss or damage to cars and motorbikes in the car park. No ball games are allowed on the park. On no occasion must bicycles be taken into the caravans. The Proprietors shall not be liable for injury, death, loss, damage, accident or additional expense, however caused, occasioned to or incurred by any guest or other person.

COMPLAINTS - If guests have a problem or complaint during their holiday, they should in the first instance bring this to the attention of the Reception, where it will be dealt with as sympathetically and helpfully as possible. Please note that in order for us to investigate and implement corrective action wherever necessary, the Company cannot entertain complaints made after a guest has left the Park.

All of our staff are trained to be courteous and polite to guests, and we expect our guests to extend the same courtesy to our staff. Any person who is rude to our staff will be asked to leave the Park and no refunds will be given.



SMOKING IS NOT PERMITTED IN ANY OF OUR ACCOMMODATION



Introduction

Thank you for your interest in Cheverton Copse Holiday Park. Please take time to read through the following information carefully, and we look forward to welcoming you to our Holiday Park.

Descriptions of our Accommodation

All of our caravans have a toilet, basin & shower, 8 channel colour TV, gas cooker, gas or electric fire, and fridge. All are fully equipped with crockery and cooking utensils, duvets, pillows and bed linen. All you need to bring are towels and tea towels. Full details and images of all our accommodation can be found on our website www.chevertoncopse.com. Smoking is not permitted in any of our caravans.

CHESHIRE - SLEEPS 4 (28 x 10 FOOT) - BRONZE RATING

This accommodation offers excellent value for money for families on a budget. An average size caravan with a double and twin bedroom and galley style kitchen. Heating to the lounge only.

SUFFOLK - SLEEPS 6 (34 x 10 FOOT) - SILVER RATING

A mid range 3 bedroom caravan with a double and 2 twin bedrooms. Comfortable lounge / dining area and galley style kitchen complete with microwave. Heating to the lounge only.

SUSSEX 10 - SLEEPS 4/6 (30 x 10 FOOT) - SILVER RATING

A good quality modern caravan, with a double and twin bedroom, plus the option of a pull-out sofa bed in the lounge (@ £25 charge), which would be suitable for an adult or 2 children. There is also panel heating to the bedrooms and shower room, plus a microwave.

SURREY - SLEEPS 6/8 (35 x 10 FOOT) - SILVER RATING

A good quality modern three bedroom caravan. These are very comfortable with a double and two twin bedrooms. Option of a pull-out sofa bed in the lounge (@ £25 charge), which would be suitable for an adult or 2 children. They have panel heating in the bedrooms and shower room, plus a microwave.

SUSSEX 12 - SLEEPS 4/6 (28 x 12 FOOT) - GOLD RATING

The Sussex 12 is a great quality modern caravan. It has a double and twin bedroom, with the option of a pull-out sofa bed in the lounge (@ £25 charge), which would be suitable for an adult or 2 children. There is also panel heating to the bedrooms and shower room, plus a microwave.

CHICHESTER - SLEEPS 6 (36 x 12 FOOT) - GOLD RATING

A great quality double glazed & centrally heated caravan with central lounge / kitchen area with double bedroom and shower room to one end and 2 twin bedrooms and W/C to the other end. Microwave also provided.

ARUNDEL 2 - SLEEPS 4/6 (35 x 12 FOOT) - PLATINUM RATING

An excellent quality modern caravan, with full double glazing and central heating. Double and twin bedroom, with option of a pull-out sofa bed in the lounge (@ £25 charge). (suitable for 1 adult or 2 children). Microwave also provided. 21" TV/DVD player.

ARUNDEL 3 - SLEEPS 6/8 (35 x 12 FOOT) - PLATINUM RATING

An excellent quality modern caravan, with full double glazing and central heating. Double and 2 twin bedrooms, with option of a pull-out sofa bed in the lounge (@ £25 charge). (suitable for 1 adult or 2 children). Microwave also provided. 21" TV/DVD player.

HAMPSHIRE - SLEEPS 4 (35 x 12 FOOT) - PLATINUM PLUS RATING

Brand new contemporary unit for 2009 in a secluded location. Full double glazing and central heating, double and twin bedroom, widescreen LCD TV, DVD player, TV in master bedroom, full size fridge / freezer, microwave, complete with decking and table & chairs.

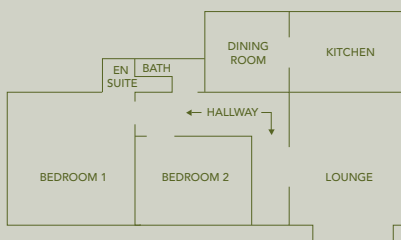

Cheverton Cottage - Sleeps 4/6

Cheverton Cottage is an individual self catering accommodation with its own entrance. It has a double bedroom and a second bedroom with bunkbeds, plus the option of a pull-out sofa bed in the lounge. The kitchen is fully equipped with cooker, fridge freezer, microwave, and toaster. It has a separate dining room, main bathroom and en-suite shower room to the lounge. The lounge area comes complete with TV, DVD and freeview satellite channels. Gas central heating and double glazed. Plus large conservatory. Smoking is not permitted in Cheverton Cottage.

Ferry 2010 Tariff

Departure Date	RED FUNNEL		WIGHTLINK	
	Southampton - East Cowes Up to 4 nights	Southampton - East Cowes 5 nights or more	Portsmouth - Fishbourne & Lymington - Yarmouth Up to 4 nights	Portsmouth - Fishbourne & Lymington - Yarmouth 5 nights or more
1st Jan - 1st April	53.00	63.00	58.00	69.00
2nd April - 5th April	90.00	122.00	85.00	96.00
6th April - 27th May	58.00	77.00	58.00	69.00
28th May - 31st May	90.00	122.00	85.00	96.00
1st June - 9th June	58.00	77.00	58.00	69.00
10th June - 14th June	90.00	122.00	58.00	69.00
15th June - 22nd July	58.00	77.00	69.00	88.00
23rd July - 30th August	67.00 or 90.00 for Saturday travel	93.00 or 122.00 for Saturday travel	69.00 or 96.00 for Saturday travel	88.00 or 115.00 for Saturday travel
31st Aug - 8th Sept	69.00	93.00	69.00	88.00
9th Sept - 13th Sept	90.00	122.00	69.00	88.00
14th Sept - 1st Oct	57.00	77.00	69.00	88.00
2nd Oct - 31st Dec	53.00	63.00	58.00	69.00

PLEASE NOTE:

The prices shown above are for a car (not exceeding 5.5 metres in length and 2.26 metres in height) and up to 6 people.

For vehicles over 2.26 metres in height and/or exceeding 5.5 metres in length, prices are available on request. (Don't forget to include roof boxes, roof racks, bike racks or towed vehicles in the measurements).

Remember to indicate your total length of vehicles on the booking form to ensure you are allocated the correct space on the ferry.

All of the above fares are subject to change by the ferry companies depending on the availability of our trade rates. These rates may also be subject to a fuel surcharge by the ferry companies. We will be pleased to confirm your ferry cost at the time of booking.

Ferry tickets will be issued two weeks prior to date of travel and after receipt of your final balance. An administration charge of £5 will be made for any ferry booking alterations.

Red Funnel and Wightlink have conditions of carriage which we request you view online at www.redfunnel.co.uk or www.wightlink.co.uk.

Static Caravans 2010 Tariff

Berth Bedrooms	Cheshire 4 2	Suffolk 4-6 3	Sussex 10 4-6 2	Sussex 12 4-6 2	Surrey 6-8 3	Chichester 6-8 3	Arundel 2 4-6 2	Arundel 3 6-8 3	Hampshire 4 2	Cottage 4-6 2
20th March	265	285	285	315	295	335	435	465	475	495
27th March	295	365	365	415	395	435	525	555	575	595
3rd April	295	365	365	415	395	435	525	555	575	595
10th April	275	335	315	355	375	395	465	495	525	555
17th April	275	335	315	355	375	395	465	495	525	555
24th April	275	335	315	355	375	395	465	495	525	555
1st May	295	355	345	375	395	425	485	515	545	575
8th May	295	355	345	375	395	425	485	515	545	575
15th May	295	395	385	435	415	455	525	515	545	575
22nd May	425	515	505	525	545	565	625	645	695	715
29th May	425	515	505	525	545	565	625	645	695	715
5th June	345	425	395	455	475	475	535	555	575	625
12th June	345	425	395	455	475	475	535	555	575	625
19th June	395	475	445	495	525	525	585	625	655	725
26th June	395	475	445	495	525	525	585	625	655	725
3rd July	395	475	445	495	525	525	585	625	655	725
10th July	395	475	445	495	525	525	585	625	655	725
17th July	495	565	525	585	595	625	675	715	750	850
24th July	495	565	525	585	595	625	675	715	750	850
31st July	495	565	525	585	595	625	675	715	750	850
7th August	495	565	525	585	595	625	675	715	750	850
14th August	495	565	525	585	595	625	675	715	750	850
21st August	495	565	525	585	595	625	675	715	750	850
28th August	355	415	385	445	445	475	545	575	675	615
4th Sept to 30th October	265	325	295	345	365	365	475	495	575	495

Rates above are for 7 nights, and include VAT @ 17.5 %, all gas, electricity and bedding. Prices are shown in £s per accommodation unit per week. Short breaks are available minimum 3 night stay during early and late season. Rates are pro rata of the above. Please ring for availability.

Check out our website www.chevertoncopse.com for special offers